

GROUPEMENT SIMPAR-EL MADINA

CONSTRUCTION D'UN ENSEMBLE RESIDENTIEL SIS A CHOUTRAMA HSC1-HSC2

"RESIDENCE SAF-SAF I"

Appa-: C8 Type :F5 Niveau:2ème ETAGE Bloc-C-

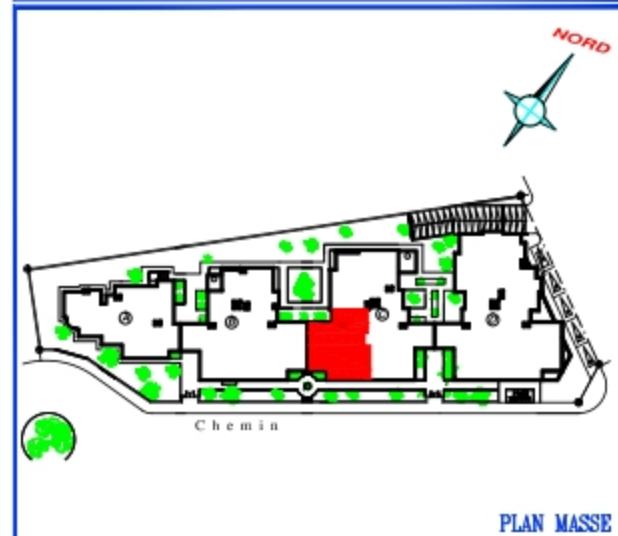

PLAN MASSE



| DESIGNATION | SURFACE (m ²) approximative |
|---|--|
| Salon-S.A.M | 24.00 |
| Chambre des parents | 15.57 |
| Chambre 1 | 13.13 |
| Chambre 2 | 11.38 |
| Cuisine | 12.40 |
| S.D.B. | 5.44 |
| S.D.E. | 2.05 |
| Hall | 7.99 |
| Dégagement | 4.29 |
| Séchoir | 7.35 |
| Placards | 3.25 |
| Surface utile | 106.85 |
| Cloisons Divises | 5.81 |
| Surface divise | 112.66 |
| Terrasse(s) couverte(s) à puissance privative | 13.34 |
| Surfaces des cloisons indivises | 4.80 |
| Surface Hors Oeuvre | 130.80 |
| Quote part dans les parties communes | 18.81 |
| Surface du plancher | 149.61 |
| Place de parking à puissance privative | N° 23 |