

GROUPEMENT SIMPAR-EL MADINA

CONSTRUCTION D'UN ENSEMBLE RESIDENTIEL S/S A CHOUTRAMA HSC1-HSC2
"RESIDENCE SAF-SAF I"

Appa-: **A2** Type :P6 Niveau: 1^{er} ETAGE Bloc-A-

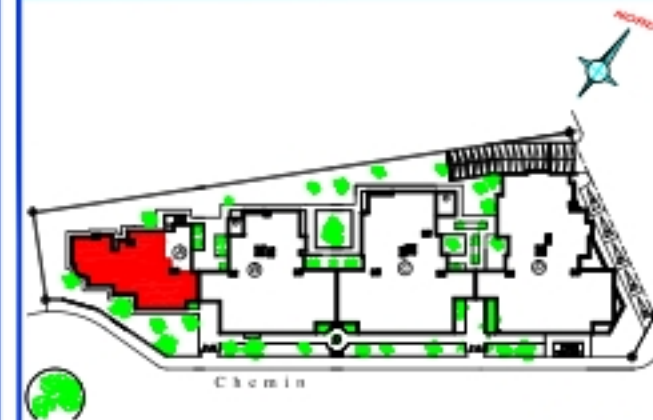
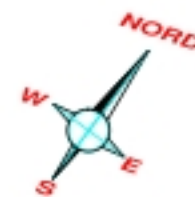

PLAN MASSE

DESIGNATION	SURFACE (m ²) approximative
Salon-S.A.M	34.32
Séjour	14.49
Chambre des parents	17.00
Chambre 1	12.34
Chambre 2	12.25
Cuisine	14.02
S.D.B.	4.74
S.D.B. parents	3.05
S.D.B.	1.56
Hall	13.82
Dégagement	7.89
Dressing	3.89
Séchoir	4.81
Placards	4.29
Surface utile	148.89
Cloisons Divises	8.04
Surface divise	156.93
Terrasse(s) couverte(s) à piscine primitive	7.25
Surfaces des cloisons induses	25.82
Surface Hors Oeuvre	190.00
Quote part dans les parties communes	35.85
Surface du plancher	225.85
Place de parking à proximité primitive	N° 15